

**APPENDIX J: TYPICAL SECTIONS FOR THE RECOMMENDED
ALTERNATIVE**

STATE OF FLORIDA
DEPARTMENT OF TRANSPORTATION

TYPICAL SECTION PACKAGE

STATE ROAD 7
PALM BEACH COUNTY

FINANCIAL PROJECT ID 229664-3-52-01
FROM 60TH ST. NORTH
TO NORTHLAKE BLVD.

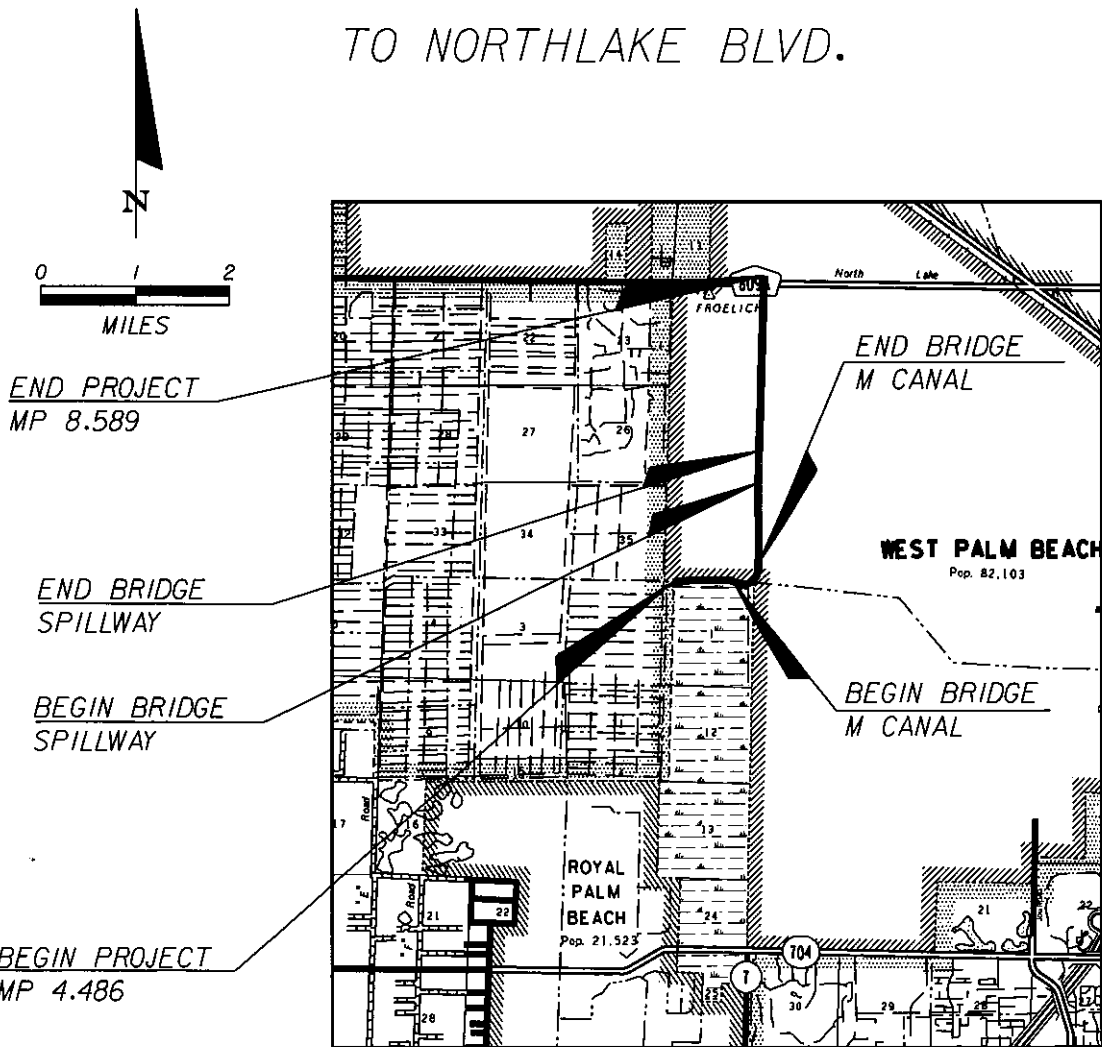

PROJECT IDENTIFICATION

FINANCIAL PROJECT ID 229664-3-52-01 COUNTY (SECTION) PALM BEACH
 PROJECT DESCRIPTION SR 7 FROM 60TH ST. NORTH TO NORTHLAKE BLVD.

PROJECT CONTROLS

FUNCTIONAL CLASSIFICATION

- () RURAL
 (X) URBAN
 () FREEWAY/EXPWY. () MAJOR COLL.
 (X) PRINCIPAL ART. () MINOR COLL.
 () MINOR ART. () LOCAL

HIGHWAY SYSTEM

- Yes No
 (X) () NATIONAL HIGHWAY SYSTEM
 () (X) FLORIDA INTRASTATE HIGHWAY SYSTEM
 () (X) STRATEGIC INTERMODAL SYSTEM
 (X) () STATE HIGHWAY SYSTEM
 () (X) OFF STATE HIGHWAY SYSTEM

ACCESS CLASSIFICATION

- () 1 - FREEWAY
 () 2 - RESTRICTIVE w/Service Roads
 (X) 3 - RESTRICTIVE w/660 ft. Connection Spacing
 () 4 - NON-RESTRICTIVE w/2640 ft. Signal Spacing
 () 5 - RESTRICTIVE w/440 ft. Connection Spacing
 () 6 - NON-RESTRICTIVE w/1320 ft. Signal Spacing
 () 7 - BOTH MEDIAN TYPES

TRAFFIC

	YEAR	AADT
CURRENT	<u>2011</u>	<u>N/A</u>
OPENING	<u>2020</u>	<u>17,900</u>
DESIGN	<u>2040</u>	<u>22,800</u>

DISTRIBUTION

DESIGN SPEED	<u>45</u>	K	<u>9%</u>
POSTED SPEED	<u>45</u>	D	<u>67%</u>
		T24	<u>8%</u>

CRITERIA

- (X) NEW CONSTRUCTION / RECONSTRUCTION
 () RRR INTERSTATE / FREEWAY
 () RRR NON-INTERSTATE / FREEWAY
 () TDLC / NEW CONSTRUCTION / RECONSTRUCTION
 () TDLC / RRR
 () MANUAL OF UNIFORM MINIMUM STANDARDS
 (FLORIDA GREENBOOK)(OFF-STATE HIGHWAY SYSTEM ONLY)

DESIGN SPEED APPROVALS

 DISTRICT DESIGN ENGINEER DATE 7-25-14

 DISTRICT TRAFFIC OPERATIONS ENGINEER DATE

LIST ANY POTENTIAL EXCEPTIONS AND VARIATIONS RELATED TO TYPICAL SECTION ELEMENTS:
 NONE

LIST MAJOR STRUCTURES LOCATION/DESCRIPTION - REQUIRING INDEPENDENT STRUCTURE DESIGN:

SR 7 BRIDGE OVER M CANAL
 SR 7 BRIDGE OVER SPILLWAY

LIST MAJOR UTILITIES WITHIN PROJECT CORRIDOR:

AT&T, WEST PALM BEACH UTILITIES, COMCAST, FLORIDA PUBLIC UTILITIES, FP&L

LIST OTHER INFORMATION PERTINENT TO DESIGN OF PROJECT:

ROUNDAABOUTS AT 60TH STREET NORTH AND IBIS ENTRANCE

PROJECT IDENTIFICATION

FINANCIAL PROJECT ID 229664-3-52-01 FEDERAL AID PROJECT NO. 4752-036 COUNTY NAME PALM BEACH
 SECTION NO. 9327000 ROAD DESIGNATION SR 7 LIMITS/MILEPOST M.P. 4.486 TO M.P. 8.589
 PROJECT DESCRIPTION SR 7 FROM 60TH ST. NORTH TO NORTHLAKE BLVD.

PROPOSED ROADWAY TYPICAL SECTION

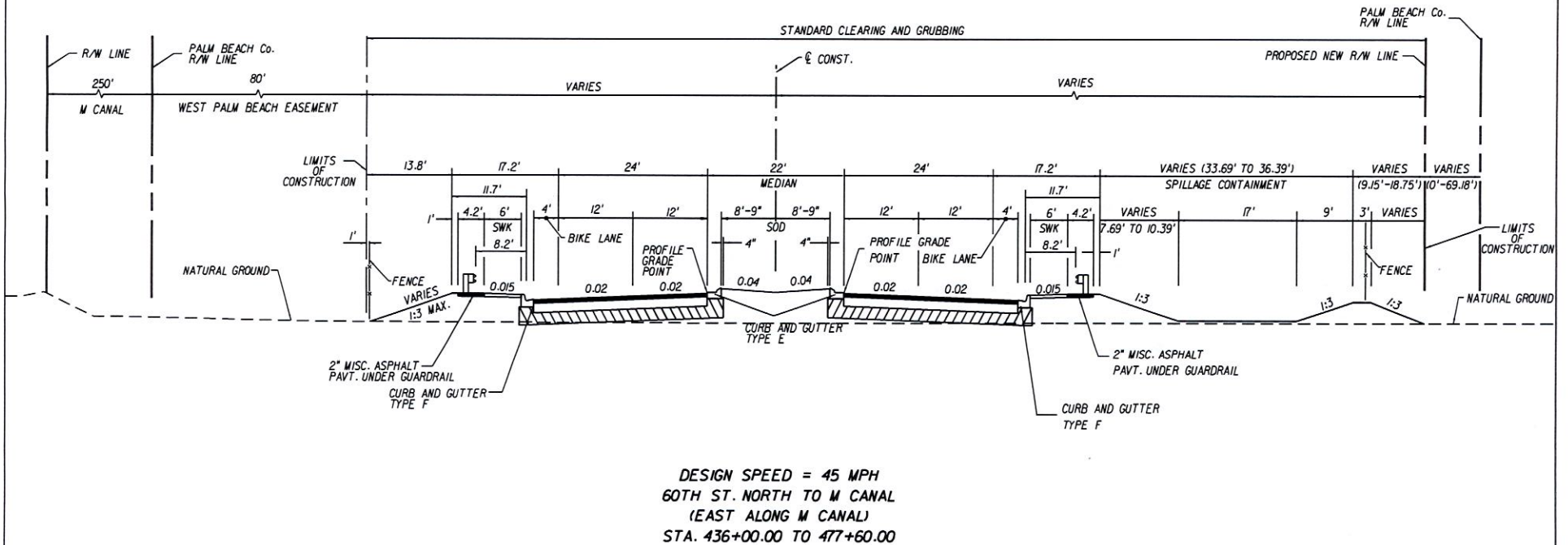

APPROVED BY: MARTIN H. WORKMAN, P.E. Date <u>4/7/14</u>	PDOT CONCURRENCE Date <u>4/25/14</u> HOWARD A. WEBB, P.E. FDOT District Design Engineer	RECOMMENDED BY: Date <u>4/23/14</u> RICHARD YOUNG, P.E. FDOT District Project Development Engineer	PALM BEACH COUNTY CONCURRENCE Date <u>7/23/14</u> OMELIO A. FERNANDEZ, P.E. Director, Roadway Production Division
--	--	---	--

PROJECT IDENTIFICATION

FINANCIAL PROJECT ID 229664-3-52-01 FEDERAL AID PROJECT NO. 4752-036 COUNTY NAME PALM BEACH
 SECTION NO. 9327000 ROAD DESIGNATION SR 7 LIMITS/MILEPOST M.P. 4.486 TO M.P. 8.589
 PROJECT DESCRIPTION SR 7 FROM 60TH ST. NORTH TO NORTHLAKE BLVD.

PROPOSED ROADWAY TYPICAL SECTION

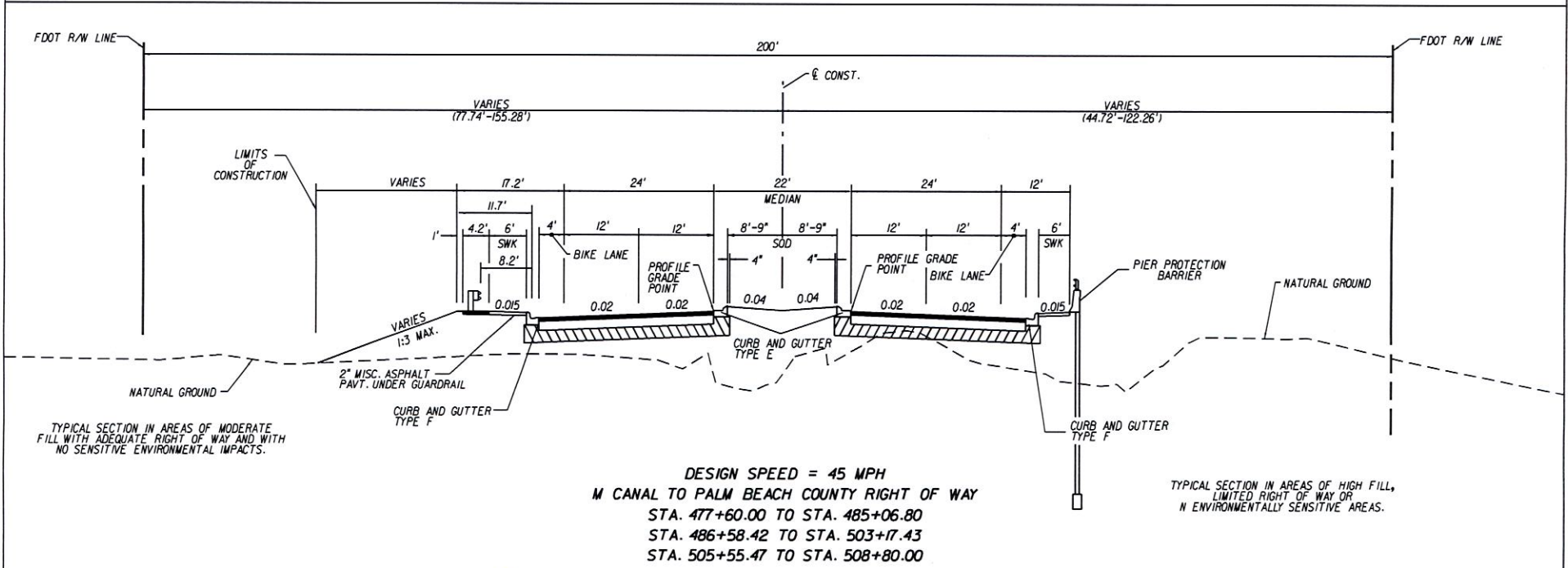

APPROVED BY: MARTIN H. WORKMAN, P.E. Date <u>4/21/14</u>	FDOT CONCURRENCE Date <u>4-23-14</u> HOWARD A. WEBB, P.E. FDOT District Design Engineer	RECOMMENDED BY: Date <u>4/23/14</u> RICHARD YOUNG, P.E. FDOT District Project Development Engineer	PALM BEACH COUNTY CONCURRENCE Date <u>7/23/14</u> OMELIO A. FERNANDEZ, P.E. Director, Roadway Production Division
---	--	---	--

PROJECT IDENTIFICATION

FINANCIAL PROJECT ID 229664-3-52-01 FEDERAL AID PROJECT NO. 4752-036 COUNTY NAME PALM BEACH
 SECTION NO. 93270000 ROAD DESIGNATION SR 7 LIMITS/MILEPOST M.P. 4.486 TO M.P. 8.589
 PROJECT DESCRIPTION SR 7 FROM 60TH ST. NORTH TO NORTHLAKE BLVD.

PROPOSED ROADWAY TYPICAL SECTION

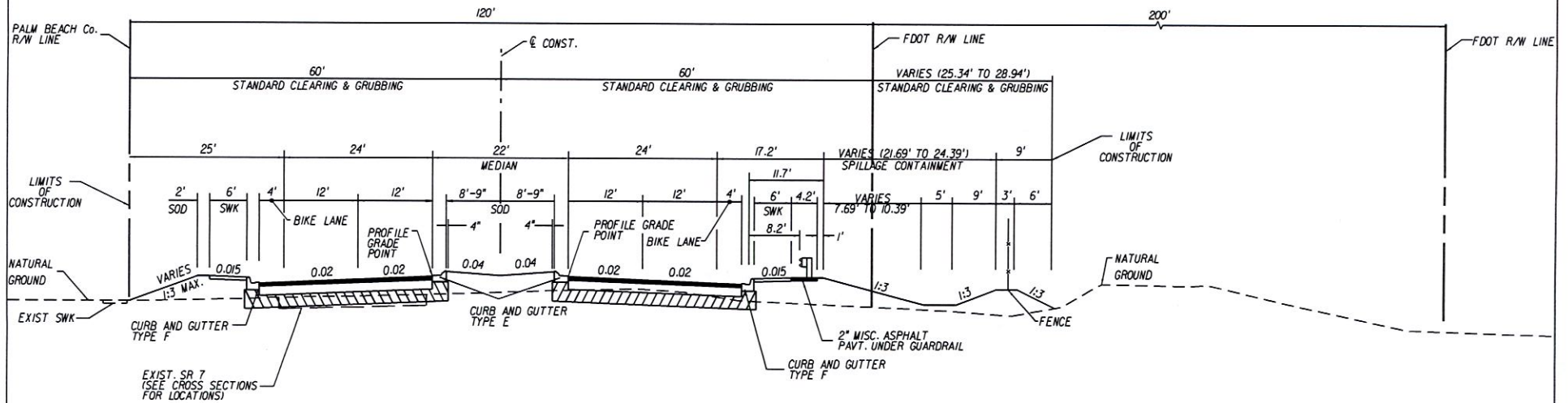

DESIGN SPEED = 45 MPH
 FROM PALM BEACH COUNTY RIGHT OF WAY TO NORTHLAKE BLVD.
 STA. 508+80.00 TO STA. 652+64.37

APPROVED BY: MARTIN H. WORKMAN, P.E. Engineer of Record Signature	FDOT CONCURRENCE HOWARD A. WEBB, P.E. FDOT District Design Engineer	RECOMMENDED BY: RICHARD YOUNG, P.E. FDOT District Project Development Engineer	PALM BEACH COUNTY CONCURRENCE OMELIO A. FERNANDEZ, P.E. Director, Roadway Production Division
Date <u>4/7/14</u>	Date <u>4-25-14</u>	Date <u>4/23/14</u>	Date <u>7/23/14</u>

PROJECT IDENTIFICATION

FINANCIAL PROJECT ID 229664-3-52-01 FEDERAL AID PROJECT NO. 4752-036 COUNTY NAME PALM BEACH
 SECTION NO. 9327000 ROAD DESIGNATION SR 7 LIMITS/MILEPOST M.P. 4.486 TO M.P. 8.589
 PROJECT DESCRIPTION SR 7 FROM 60TH ST. NORTH TO NORTHLAKE BLVD.

PROPOSED STRUCTURE TYPICAL SECTION

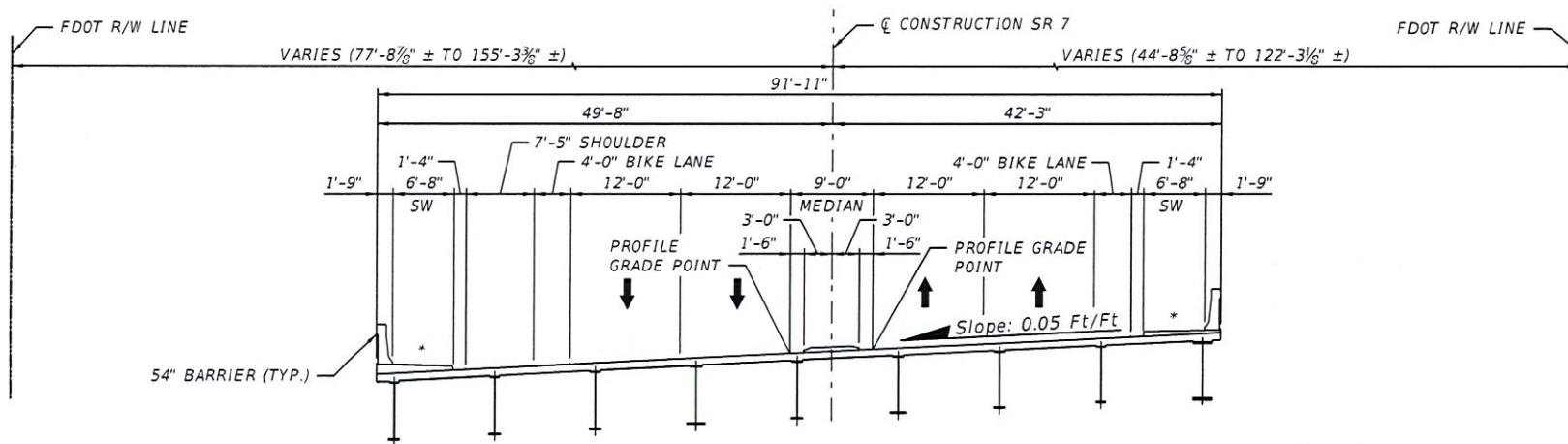

LEGEND:
 * SIDEWALK CROSS-SLOPE = 0.015 FT/FT

DESIGN SPEED = 40 mph
 SR7 BRIDGE OVER M CANAL
 STA. 485+06.80 TO STA. 486+58.42

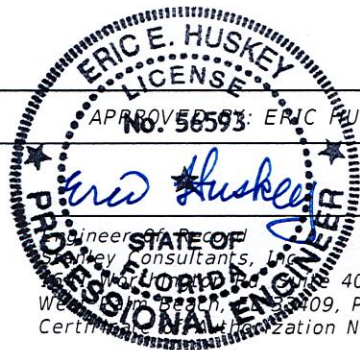

APPROVED BY: ERIC HUSKEY, P.E.
No. 56593

4-7-2014
Date

Eric Huskey Consultants, Inc.
 400
 W. ...
 Ph. 561-689-7444
 Registration No. 1978

FDOT CONCURRENCE

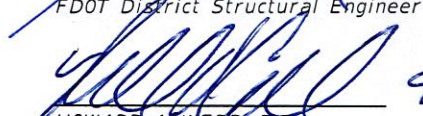
 FDOT District Structural Engineer 4/25/14 Date

 HOWARD A. WEBB, P.E. 4-25-14 Date
 FDOT District Design Engineer

RECOMMENDED BY

 RICHARD YOUNG, P.E. 4/23/14 Date
 FDOT District Project Development Engineer

PROJECT IDENTIFICATION

FINANCIAL PROJECT ID 229664-3-52-01 FEDERAL AID PROJECT NO. 4752-036 COUNTY NAME PALM BEACH
 SECTION NO. 9327000 ROAD DESIGNATION SR 7 LIMITS/MILEPOST M.P. 4.486 TO M.P. 8.589
 PROJECT DESCRIPTION SR 7 FROM 60TH ST. NORTH TO NORTHLAKE BLVD.

PROPOSED STRUCTURE TYPICAL SECTION

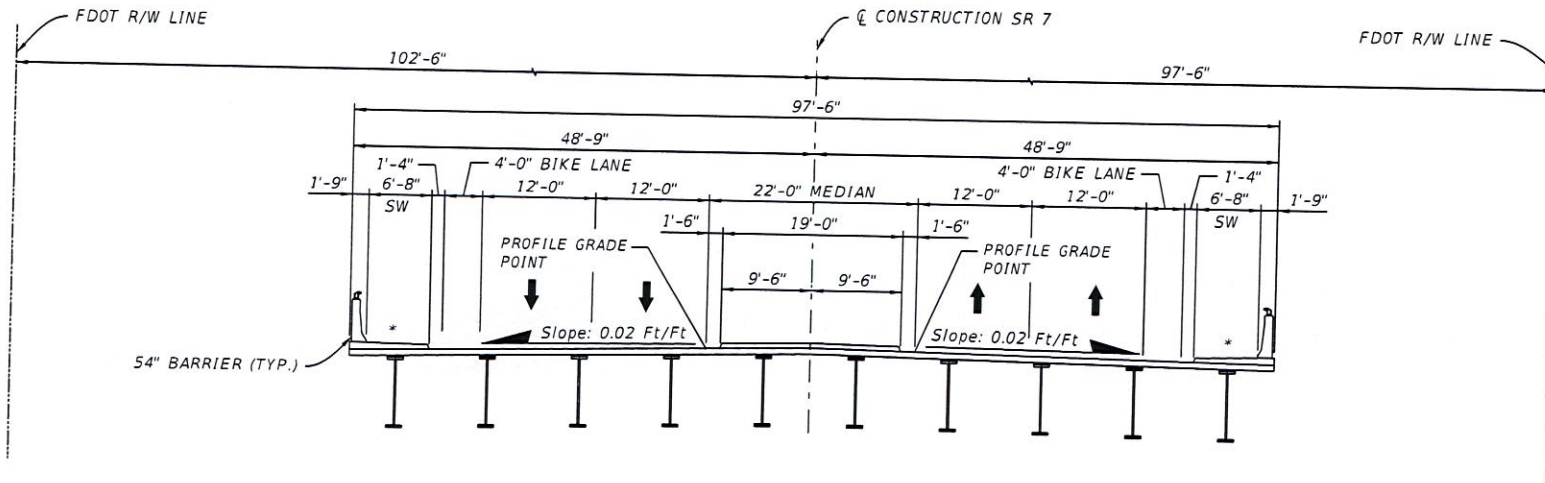

DESIGN SPEED = 45 mph
 SR7 BRIDGE OVER SPILLWAY
 STA. 503+17.43 TO STA. 505+55.47

LEGEND:
 * SIDEWALK CROSS-SLOPE = 0.015 FT/FT



APPROVED BY: ERIC HUSKEY, P.E.

Eric Huskey
4-7-2014
Date

FDOT CONCURRENCE

[Signature] 4/25/14
 FDOT District Structural Engineer Date
[Signature] 4-25-14
 HOWARD A. WEBB, P.E.
 FDOT District Design Engineer Date

RECOMMENDED BY

[Signature] 4/23/14
 RICHARD YOUNG, P.E.
 FDOT District Project Development Engineer Date

STATE OF FLORIDA
DEPARTMENT OF TRANSPORTATION

TYPICAL SECTION PACKAGE

STATE ROAD 7
PALM BEACH COUNTY

FINANCIAL PROJECT ID 229664-4-32-01
FROM NORTH OF SR 704 (OKEECHOBEE BLVD.)
TO 60TH ST. NORTH

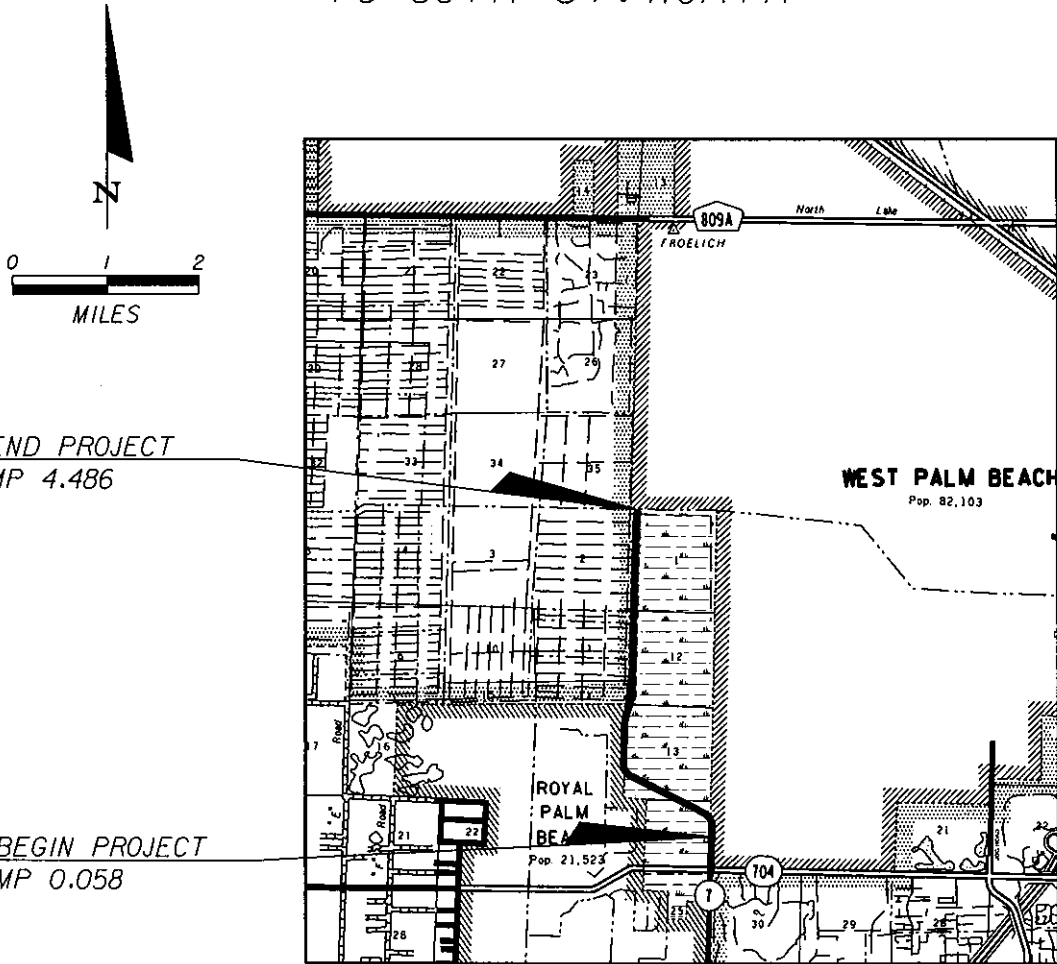

PROJECT IDENTIFICATION

FINANCIAL PROJECT ID 229664-4-32-01 COUNTY (SECTION) PALM BEACH
 PROJECT DESCRIPTION SR 7 FROM NO. OF SR 704 (OKEECHOBEE BLVD.) TO 60TH ST. NORTH

PROJECT CONTROLS

FUNCTIONAL CLASSIFICATION

- () RURAL
 (X) URBAN
- () FREEWAY/EXPWY. () MAJOR COLL.
 (X) PRINCIPAL ART. () MINOR COLL.
 () MINOR ART. () LOCAL

HIGHWAY SYSTEM

- Yes No
- (X) () NATIONAL HIGHWAY SYSTEM
 () (X) FLORIDA INTRASTATE HIGHWAY SYSTEM
 () (X) STRATEGIC INTERMODAL SYSTEM
 (X) () STATE HIGHWAY SYSTEM
 () (X) OFF STATE HIGHWAY SYSTEM

ACCESS CLASSIFICATION

- () 1 - FREEWAY
 () 2 - RESTRICTIVE w/Service Roads
 (X) 3 - RESTRICTIVE w/660 ft. Connection Spacing
 () 4 - NON-RESTRICTIVE w/2640 ft. Signal Spacing
 () 5 - RESTRICTIVE w/440 ft. Connection Spacing
 () 6 - NON-RESTRICTIVE w/1320 ft. Signal Spacing
 () 7 - BOTH MEDIAN TYPES

TRAFFIC

	YEAR	AADT
CURRENT	<u>2009</u>	<u>4,600</u>
OPENING	<u>2020</u>	<u>37,400</u>
DESIGN	<u>2040</u>	<u>47,600</u>

DISTRIBUTION

DESIGN SPEED	<u>45</u>	K	9%
POSTED SPEED	<u>45</u>	D	67%
		T ₂₄	8%

CRITERIA

- (X) NEW CONSTRUCTION / RECONSTRUCTION
 () RRR INTERSTATE / FREEWAY
 () RRR NON-INTERSTATE / FREEWAY
 () TDLC / NEW CONSTRUCTION / RECONSTRUCTION
 () TDLC / RRR
 () MANUAL OF UNIFORM MINIMUM STANDARDS
 (FLORIDA GREENBOOK) (OFF-STATE HIGHWAY SYSTEM ONLY)

DESIGN SPEED APPROVALS

 DISTRICT DESIGN ENGINEER 7/16/14
 DATE

 DISTRICT TRAFFIC OPERATIONS ENGINEER _____
 DATE

LIST ANY POTENTIAL EXCEPTIONS AND VARIATIONS RELATED TO TYPICAL SECTION ELEMENTS:
 NONE

LIST MAJOR STRUCTURES LOCATION/DESCRIPTION - REQUIRING INDEPENDENT STRUCTURE DESIGN:
 N/A

LIST MAJOR UTILITIES WITHIN PROJECT CORRIDOR:
 AT&T, WEST PALM BEACH UTILITIES, COMCAST, FLORIDA
 PUBLIC UTILITIES, FP&L, PALM BEACH COUNTY WATER UTILITIES

LIST OTHER INFORMATION PERTINENT TO DESIGN OF PROJECT:
 N/A

PROJECT IDENTIFICATION

FINANCIAL PROJECT ID 229664-4-32-01 FEDERAL AID PROJECT NO. 4752-032 COUNTY NAME PALM BEACH
 SECTION NO. 93270000 ROAD DESIGNATION SR 7 LIMITS/MILEPOST MP 0.058 TO MP 4.486
 PROJECT DESCRIPTION SR 7 FROM NORTH OF SR 704/ OKEECHOBEE BLVD. TO 60TH ST. NORTH.

PROPOSED ROADWAY TYPICAL SECTION

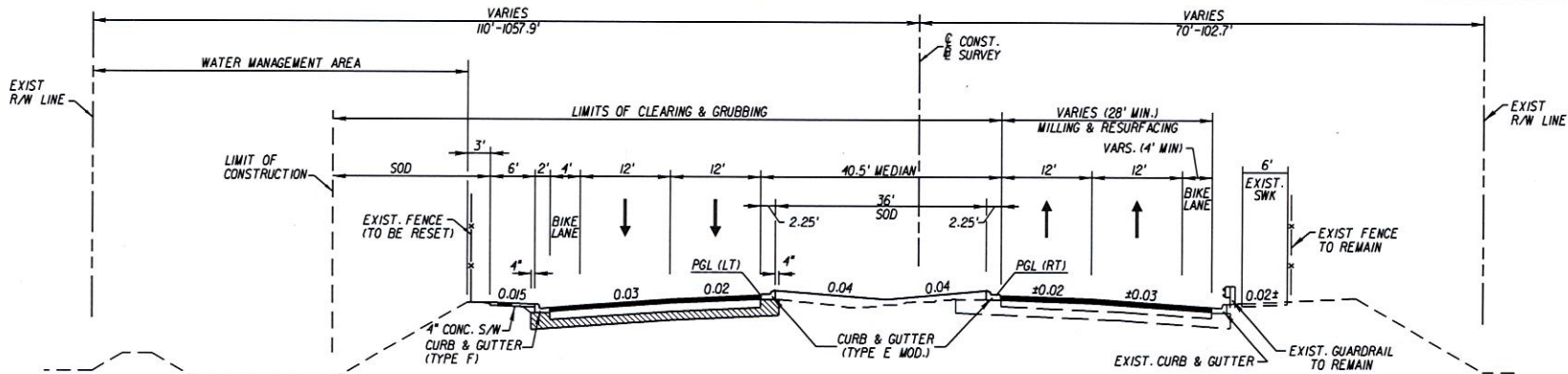

DESIGN SPEED = 45 M.P.H.
 NORTH OF OKEECHOBEE BLVD. TO PERSIMMON BLVD.
 STA 223+00.11 TO STA 382+00.00



Digitally signed by Maverick K Marshall
 DN: c=US, o=IdenTrust ACES Business Representative, ou=WANTMAN GROUP INCORPORATED, cn=Maverick K Marshall,
 0.9.2342.19200300.100.1.1=A01097
 C00000145C3B915A2000014C3
 Date: 2014.07.03 10:18:40 -04'00'

APPROVED BY: <i>Maverick Marshall, P.E.</i>	FDOT CONCURRENCE	RECOMMENDED BY:	PALM BEACH COUNTY CONCURRENCE
<i>Howard A. Webb</i> Date <u>7/11/14</u> HOWARD A. WEBB, PE FDOT District Design Engineer	<i>Richard Young</i> Date <u>7/14/14</u> RICHARD YOUNG, P.E. FDOT District Project Development Engineer	<i>Omelio A. Fernandez</i> Date <u>7/23/14</u> OMELIO A. FERNANDEZ, P.E. Director, Roadway Production Division	

PROJECT IDENTIFICATION

FINANCIAL PROJECT ID 229664-4-32-01 FEDERAL AID PROJECT NO. 4752-032 COUNTY NAME PALM BEACH
 SECTION NO. 93270001 ROAD DESIGNATION SR 7 LIMITS/MILEPOST M.P. 0.058 TO M.P. 4.486
 PROJECT DESCRIPTION SR 7 FROM NORTH OF SR 704/ OKEECHOBEE BLVD. TO 60TH ST. NORTH.

PROPOSED ROADWAY TYPICAL SECTION

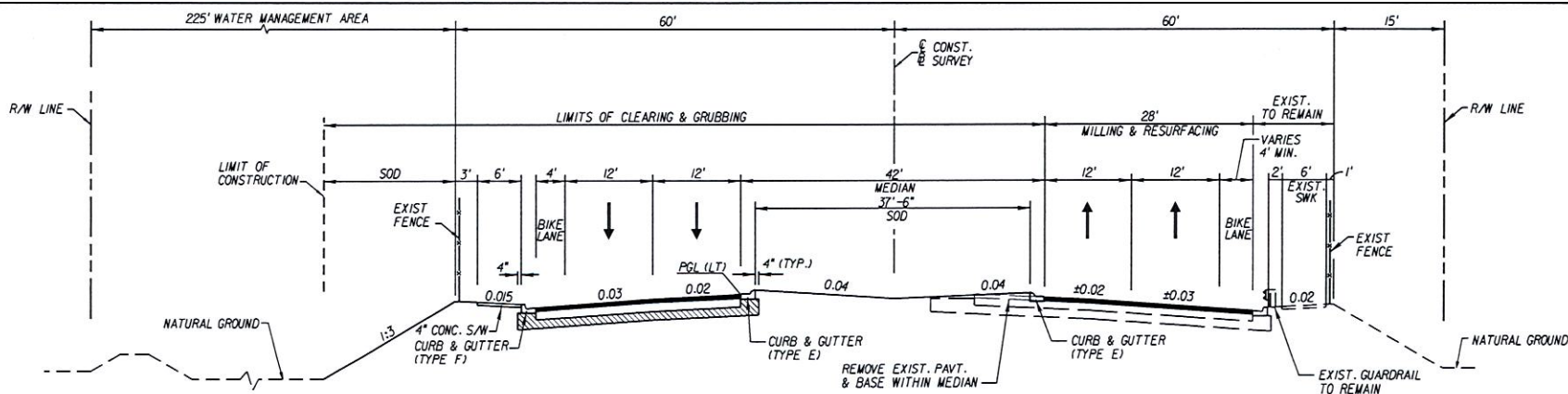

DESIGN SPEED = 45 MPH
 PERSIMMON BLVD. TO 60TH STREET NORTH
 STA. 382+00.00 TO STA. 436+00.00

APPROVED BY: MARTIN H. WORKMAN, P.E.

FDOT CONCURRENCE

RECOMMENDED BY:

PALM BEACH COUNTY CONCURRENCE

 Engineer of Record
 Signature

 HOWARD A. WEBB, P.E.
 FDOT District Design Engineer

 RICHARD YOUNG, P.E.
 FDOT District Project Development Engineer

 OMELIO A. FERNANDEZ, P.E.
 Director, Roadway Production Division